

**CUSTOM SEAT**

APPLICATION : MONKEY125 (JB02)

CODE : 610-1300050

- Thank you for purchasing Kitaco product. Read and understand the instruction before installing.

**ATTENTIONS (MUST READ)**

- CUSTOM SEAT is designed and made exclusive for MONKEY125, do not use on other models.
  - Do not modify the way which is not listed or it will cause damage and trouble.
  - We are not responsible for damages and accidents caused by assembling mistake and improper setting.
  - Please ask authorized mechanic for assembling and setting.
- Ask a specialist at specialty shop if you do not understand the role of the surrounding parts.
- Refer to the manufacturer service manual when installation.
  - Please check and make sure each part of bolts and nuts are not loose before running.

**ATTENTION !!**

- After installation, seating place is changed compared to stock seat. Please drive carefully.
- Kitaco custom seat is not completely water-proof.
- Please do not place it under heavy water for hours.
- It gets discolored under direct sunlight or long term use.
- Fire prohibited : Do not use this near fire.

**HOW TO MAINTENANCE**

- Do not use scrubbing brush with polishing powder to avoid getting scratches
- Wipe the seat with dry or wrung rag to clean the surface.

When using detergent, try somewhere unnoticeable first to see if it does not get discolored.

**PACKING LIST**

FIG	PARTS NAME	CODE	PCS	
1	CUSTOM SEAT	610-1300001BK	1	
2	SEAT STAY A REAR	610-1300002	1	
3	SEAT STAY B FRONT	610-1300003	1	
4	CAP BOLT M6x15	060-0500015	6	Tightening torque : 10N·m
5	WASHER 6x13xT1mm	090-0900006	6	

**HOW TO INSTALL**

※ Change the reusing parts with new ones if there are significant blem, fatigue or wear.

- 1) Remove stock seat, remove cushion rubber.
  - 2) Install stay (A/B) to custom seat referring to illustration below.  
(Install removed cushion rubber to stay B).
  - 3) Install custom seat with stock bolts, referring to illustration below.
- ※ Tighten the bolts little by little.
- 4) Make sure the seat is stable with tightening bolts.

M6 Tightening torque

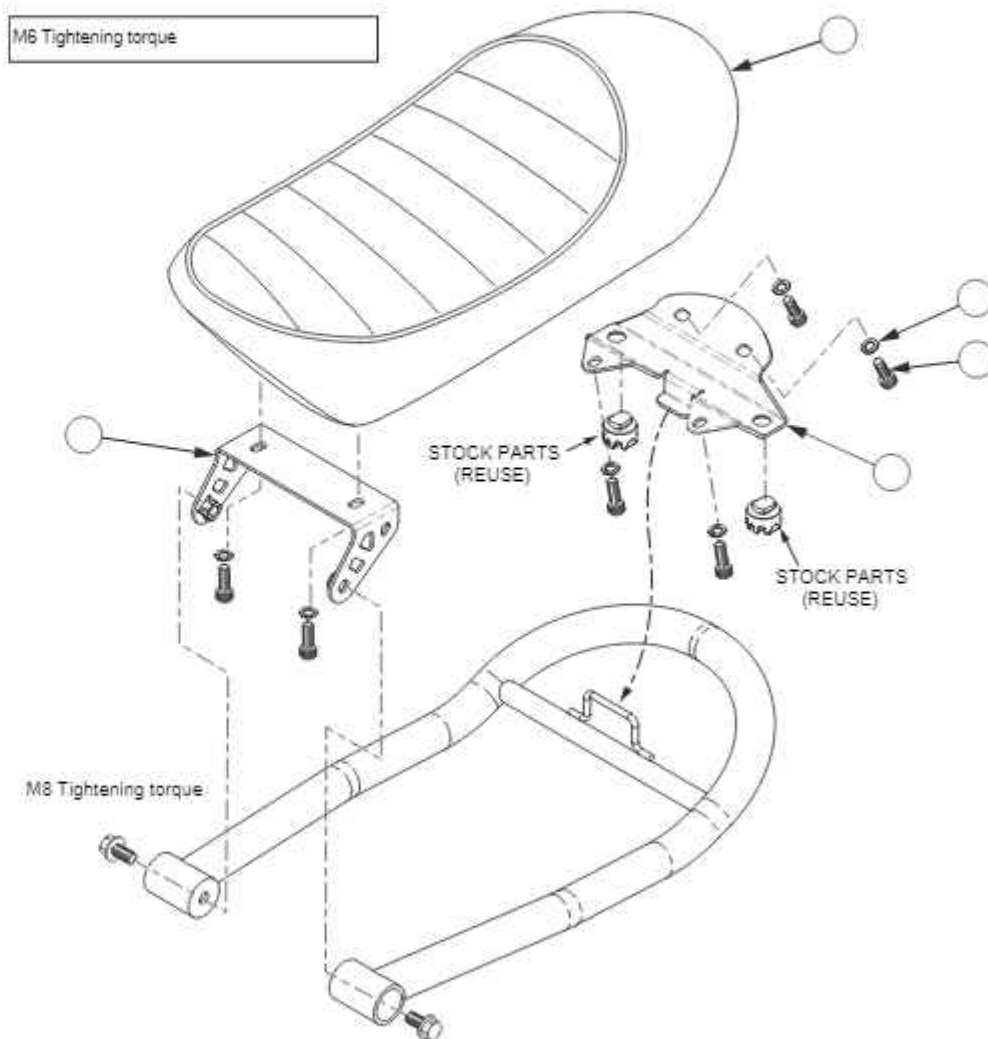

3-3-13 NAGATA,  
HIQASHI-OSAKA,  
OSAKA, 577-0015,  
JAPAN  
<http://www.kitaco.co.jp/>